



Vanguard Elite POS Installation Guide

Triple E Technologies, LLC

Version 060816.01

Triple E Technologies, LLC
P.O. Box 2677 Post Falls, ID 83877
Phone: 208.777.9300 | Fax: 208.777.9304

© 2016 Triple E Technologies, LLC

All rights reserved. No parts of the content of this work may be reproduced or transmitted in any form without the written permission of Triple E Technologies, LLC.

The information in this document is subject to change without notice. Although Triple E Technologies, LLC has attempted to ensure the accuracy of the contents of this document, this document may include errors or omissions. The examples and sample programs are for illustration only and may not be suited to your purpose. You should verify the applicability of any example or sample program before placing the software into productive use. The examples in this document may not exactly replicate your system configuration, but the functions will remain the same.

The Triple E Technologies, LLC logo and OneTouch DataManager are registered trademarks of Triple E Technologies, LLC. All other brand names and trademarks associated with Triple E Technologies, LLC products and services are trademarks of Triple E Technologies, LLC. All other brand names and trademarks in this document are the property of their respective owners.

Comments, questions, or concerns? Please email all inquiries to helpdesk@e3tek.com

Table of Contents

Overview	1
Manufacturer Supplied Components	1
Additional Required Components	1
Hardware Identification	2
Parts Diagram	2
Specifications	3
Installation	4

Overview

The Vanguard Elite POS will arrive mostly assembled and in two parts: the head and base. This guide details the procedures for attaching the head to the base and for connecting necessary components and peripherals to the unit.

Manufacturer Supplied Components

The Vanguard Elite includes the manufacturer supplied components listed below:

1. Toshiba SurePOS 500
2. Network cable
3. Key parts
4. Spare parts
5. FCC Required Safety and Regulatory Documentation
6. Toshiba Setup and Feature Documentation

Additional Required Components

- Screwdriver



Hardware Identification

Parts Diagram



1. Infrared touchscreen
2. Programmable magnetic stripe reader
3. Toshiba Light-Path Management
4. Audio Speaker
5. Cash drawer
6. Touchpad mouse
7. Built-in keyboard
8. Receipt printer

Specifications

Screen	15" IR Touchscreen
Processor	Intel Celeron G540
Service Processor	Toshiba Light-Path Management
Maximum Dimensions (HxWxD)	15"x 14.13" x 9.96"
Weight	27 lbs
System Memory	8 GB DDR3
Video Memory	Up to 256 MB via Intel DVM driver
Storage	500 GB SATA2 HDD 64 GB SSD
Expansion Slots	Express Card slot
Wireless	Optional wireless dongle cover kit
Independent Dual Video	Standard
USB Ports	1x 24v, 1x 12v, 7x USB 2.0 (3x on front tablet)
RS-232 ports	3x std, 1x powered, MSR
RJ45 Ethernet	1x Gigabit
Audio Ports/Speaker	Mic-in/line out & headphone, speakers
Cash Drawer Port	2
System Management	Toshiba Remote Management Agent (RMA); SMBIOS; Wake on LAN® (WOL); Pre-Boot Execution Environment (PXE)
Power management	Deep sleep automation; APM; ACPI
Drivers supported	UPOS 1.14.1 or higher

Installation

1. On base unit, remove top-rear cover by lifting up and sliding it out.

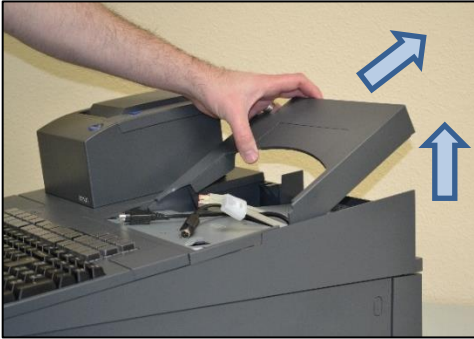

2. Remove two (2) touchscreen mounting screws located on both sides of cutout. Set screws aside for later use.

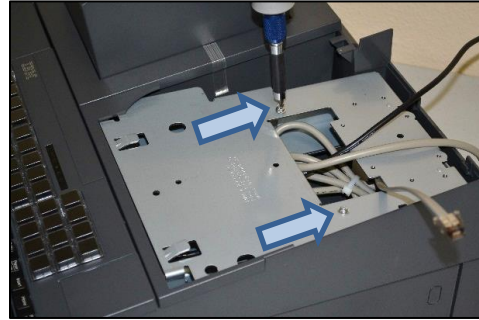

3. Remove rear touchscreen cover by pushing release tab and pulling cover out.



4. Swivel touchscreen up to access stand.



5. Pull the stand cover thumb catch up to access mounting plate.

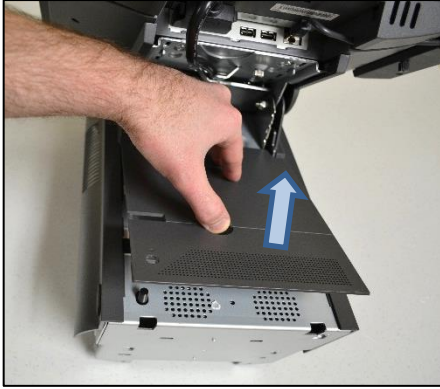

6. Place touchscreen on top of base unit.



7. Lift stand cover to visibly align mounting tabs, then slide touchscreen into place.

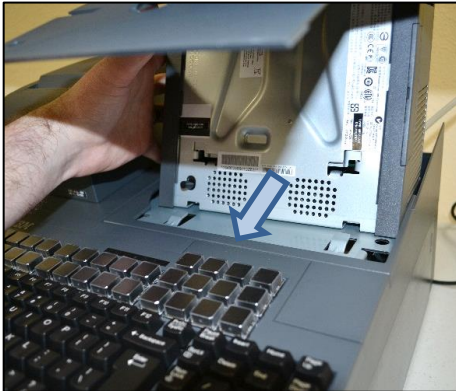

8. Snap stand cover back into place.



9. If available, connect hand scanner cable to an available port.



10. Connect cash drawer cable to Port 3A.



11. Connect network cable to network port.



12. Connect receipt printer cable to Port F.



13. If available, connect payment terminal cable to an available USB port.



14. Connect keyboard and mouse cables to corresponding ports.



15. Connect any additional peripherals to remaining available ports, if desired.



16. Remove base unit power supply handle by rotating purple release and swinging handle outwards.

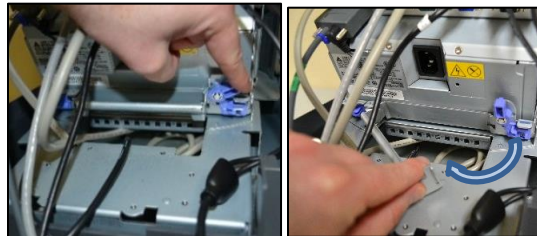

17. Connect AC adaptor to power port on rear of power supply.



18. Secure touchscreen using screws removed in Step 4.

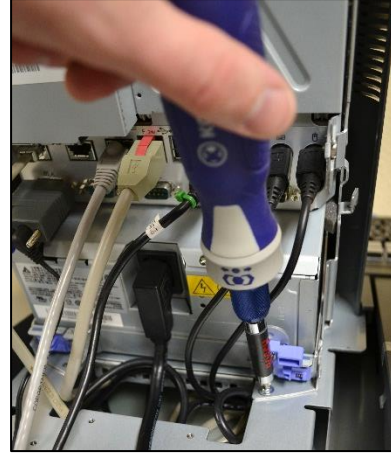

19. Reattach touchscreen power supply handle by swinging it into place and securing with purple release.

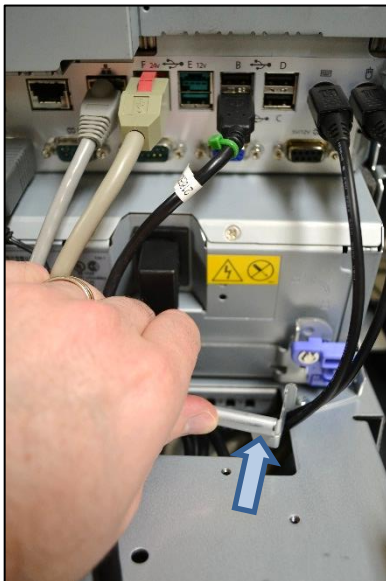

20. Gather and route external cables through rear cable cutout.

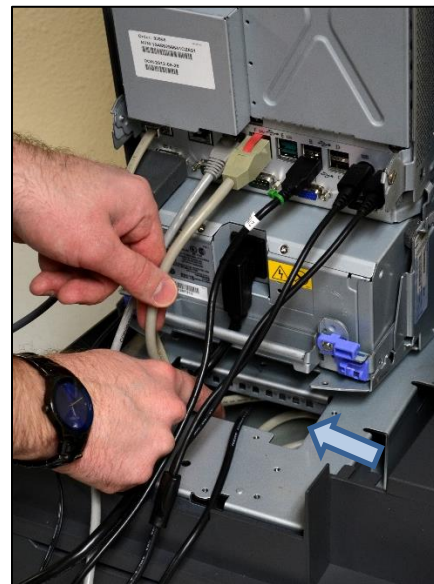

21. Snap rear touchscreen cover back into place.



22. Put base unit cover back into place.



23. Plug in AC power cord, then power on register by pressing power button on bottom of the touchscreen.



- END INSTALLATION -

Your Vanguard Elite POS is now fully assembled and ready for use. Please contact Triple E Customer Support by phone at (888) 407-6077 or by email at helpdesk@e3tek.com for assistance configuring the Point of Sale software. To learn more about using the Vanguard Point of Sale, please see our [Vanguard User Guide](#).